

# 20

# ABAS40

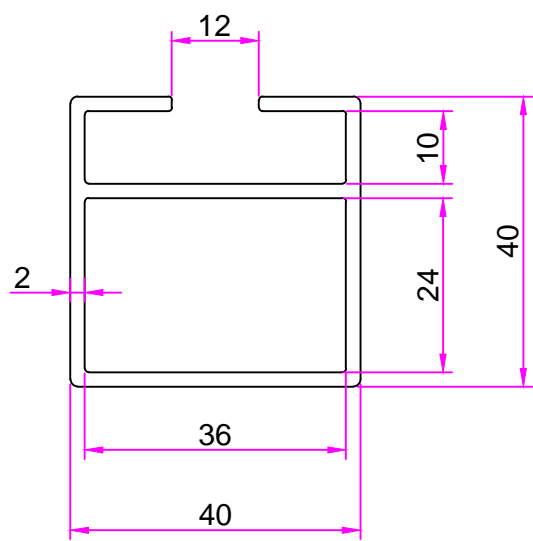

UNLESS OTHERWISE SPECIFIED TOL. ON DIMS. ARE WITHIN  $\pm 0.1\text{mm}$

PART. NO.		MATL	ALUMINIUM	PART. NO.	ABAS40
DRG. NO		DRAWN BY	A kr	09/11/16	WEIGHT/ METER
FITMENT REF.		APPROVED BY			SCALE
FITMENT DRG. NO		<b>ABAS40</b>		DATE	02/12/16
				DRG. NO.:	

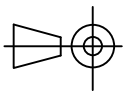

## TECHNICAL SOLUTIONS & ENGINEERS.