

21

ABAS60

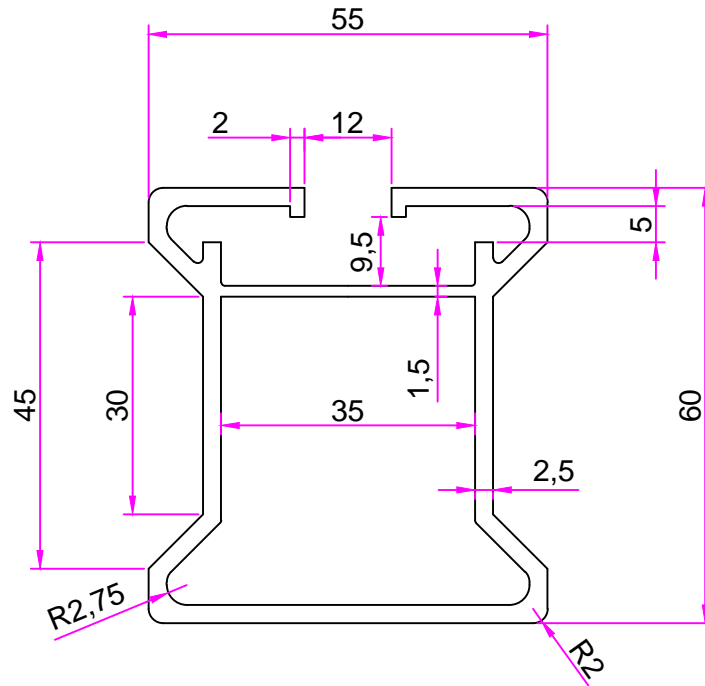

UNLESS OTHERWISE SPECIFIED TOL. ON DIMS. ARE WITHIN $\pm 0.1\text{mm}$

| | | | | | |
|-----------------|--|-------------|---------------|---------------|-----------|
| PART. NO. | | MATL | ALUMUNIUM | PART. NO. | ABAS60 |
| DRG. NO | | DRAWN BY | A kr 09/11/16 | WEIGHT/ METER | |
| FITMENT REF. | | APPROVED.BY | | SCALE | 1:1 |
| FITMENT DRG. NO | | ABAS60 | | DATE 02/12/16 | DRG. NO.: |
| | | | | | |

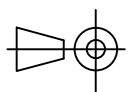

TECHNICAL SOULUTIONS& ENGINEERS.